

Studytrip Copenhagen

THURSDAY

10.00 Arrival and check in at the hotel (1).

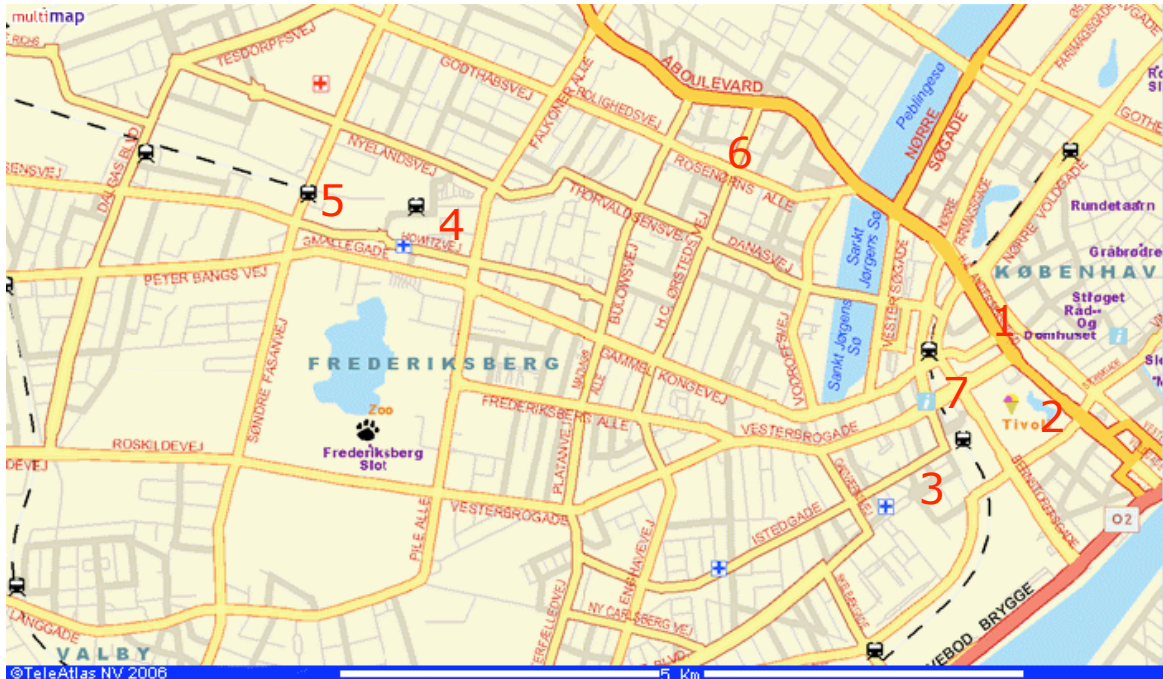

- 10.30 **Tivoli's Concerthall, 1956 (2)**
Renovated 2006 by 3xN Architects (Concertgebouw Amsterdam). Guided tour with an architect from Tivoli.
- 11.30 We walk to Reventlowsgade, where we pick up our bikes. (3)
- 12.00 We bike along Vesterbrogade and Frederiksberg Allé and end up at the New Squares of Frederiksberg.
- 12.30 Visit in the City of Frederiksberg (an independent Community), urban planning, renewal of the district. We also see the Frederiksberg Highschool by Henning Larsen Architects and visit the new squares of Frederiksberg together with the Campus of Copenhagen Business School (CBS). While we are there, we take the Metro 2 stops to the new "Flintholm Station".
- 12.30 **Frederiksberg Highschool, 2004 (4)**
Architect, Henning Larsen Architects,
The open facades interact with the plazas outside and the assembly hall and lunchroom face the urban space.
Frederiksberg local color has been preserved in the form of little green oases, indoor "schoolyards". We have a look at the school together with a representative from the school.



Frederiksberg Highschool

13.00 **Lunch** (at the CBS) – Kilen

“Kilen” – (the Wedge) – CBS 2006 (5)

Architects Lundgaard & Tranberg Architects.

First we have lunch and afterwards we are admitted to the 4th floor, where we can overlook the oval shaped atrium and the terraced landscape at the ground floor made by the finish granite, Korpi black.



Kilen-L&T Architects

15.30 We bike from Frederiksberg via Thorvaldsensvej and Danasvej to the Danish Radio’s old Concert hall, Julius Thomsens Gade.

16.00 **The Danish Radio, Old Concerthall, 1945** (6)

Architect Vilhelm Lauritzen.

A special nordic style between functionalism and modernism. Excellent detailing and delicate choice of natural materials. Guided tour.



Danish Radio’s old Concerthall

16.45 Departure from the Danish Radiohouse. We bike to the SAS Royal Hotel, Hammerichsgade.

17.15 **SAS Royal Hotel, 1960** (7)

Architect Arne Jacobsen.

We have a glass of sparkling wine at Alberto K, an elegant sky bar at the top of the building, while overlooking the city. Arne Jacobsen designed everything to the hotel, from the building down to the cutlery. The Swanchair was specially designed to the lobby. If we are lucky we might have a chance to see the famous room 606, which still is kept in the original design of Arne Jacobsen. (it is very popular among Japanese people, because the Japanese emperor stayed there).

18.30 Back to the Square Hotel 5 minutes from the SAS Royal Hotel. The bikes can be parked safely in the yard of the hotel until the next morning.

20.00 **Dinner at Café Royal**, at the bottom of the SAS Royal Hotel. We walk to the Café Royal, furnished with Arne Jacobsen famous chairs and tables.

A 2-course dinner menu + wine, water and coffee/tea is served. The menu will be the menu of the day.



Sas Royal Hotel



Swanchairs

FRIDAY the 14th September

8.15 We start at the hotel Square (1) biking along the H.C. Andersens Boulevard passing the Danish Design Center and

The Glyptoteket (old art collection, built by the founder of the Carlsberg Brewery). We proceed along Christians Brygge, pass the Black Diamond, 1999 an extension of the Royal Danish Library – by SHL Architects (8) and we catch a glimpse of The National Bank of Arne Jacobsen from 1976 (9). We cross the “Knippelsbro”, enter the quarter of Christianshavn. (inspired by early Dutch townplanning from 16th Century). Passing the entrance of Christiania, “the free town” we end up at “Holmen” (old military area), where the Opera is situated.



The black Diamond



The National Bank

9.00

The Royal Danish Opera House, 2005 (10)

Architect, Henning Larsen Architects
 We have a guided tour – back stage together with an architect from Henning Larsen Architects, who was a projectleader of the Opera Project.

The opera is equipped with the most modern stage techniques wich will be explained by the opera-guide.



The Opera



The Royal Danish
Playhouse/theater

10.15 From the Operahouse we can see The Royal Playhouse/theater across the harbour - (not finished, will open feb. 08) – Lundgaard & Tranberg Architects.

10.30 After the visit in the Operahouse, we bike via Prinsessegade and Amager Fælledvej to the "Ørestad North". On our way we make a short stop, where we will have a look at the Bikuben College (dormitory), designed by AART Architects. A very daring design to Danish standard – (almost Dutch-like).



Bikuben College

11.00 Arrival at "Ørestad North" – Part of the Ørestad, the new large urban development of Copenhagen. The city has been developed on a basis of an architectural competition, won in 1994 by the finish architects ARKKI. The Ørestad North is the Copenhagen's new knowledge center for culture, media and communication. The area is one of the four quarters of the Ørestad, which is most completed and which is expected to be finished within the next 5 years.

The IT-University, 2003 (11)

Architect, Henning Larsen Architects.

The two buildings surround an impressive atrium. We walk through the atrium hall of the IT-University and look at the fascinating suspended meetingrooms and balconies above.

The Tietgen College, 2005 (12)

Architect, Lundgaard & Tranberg Architects.

Halls of residence for 360 students in a round shaped building, clad with tombak (bronzelike metal plate) and big super graphic signs at the ground floor. Some of the

rooms are cantilevered at the inside and the outside of the circular building - almost looking like a giant porcupine.



The IT-University and the Tietgen College

12.00

The Gemini Residence, 2004, Islands Brygge (13)

The dutch architects MVRDV won a competition in 1990ties and came up with a genius idea, which none of the other entries did – to build the flats on the outside of the old concrete silos. The Danish Architects/JJW Architects detailed and finished the building 2004. If possible, we see the lobby.



Gemini Residence

12.30

Lunch at the Islands Brygge Culture house, where we overlook the harbour and all the new buildings. The Culture house is a fine piece of architecture from the late 1990ties.

14.00

The Danish Radio, New Concerthall, 2008 (DR-City)(14)

Architect Jean Nouvel.

A cobalt blue cube with a hight of 45 m, which will be able to seat 1800. The facade will consist of one enormous blue screen, which will project images from concerts and works of art creating a living wall outside the concert hall.

The concert hall is scdeduled to 2008 - We will meet architect an architect from Atelier Jean Nouvel outside the project office of Jean Nouvel. He will brief us shortly about the concert hall and show us the acustic model.

Jean Nouvel himself is very inspired by Danish architecture and especially he is a great admirer of the Louisiana Museum and the architecture of the museum.

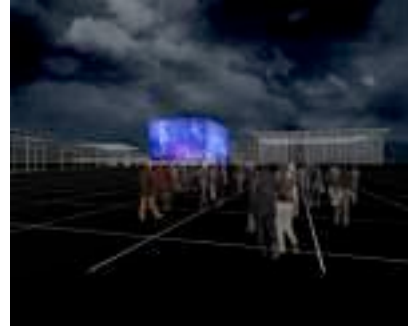

Concerthall – project/Jean Nouvel

15.00 We leave "Ørestad North" and bike back to Islands Brygge, where we cross the new bridge by Dissing & Weitling Architects and the Dybbøls Bridge to Reventlovsgade, where we return the bikes at "Rentabike"

15.30 Reventlovsgade "Rent a Bike"

20.00 **Dinner at Restaurant Zeleste, Store Strandstræde 6 in Nyhavn. (15)**

(half an hours walk from the hotel through the walking- and shoppingstreet "Strøget". You will cross the Kongens Nytorv, a beautiful square, before you turn towards Nyhavn and restaurant Zeleste

Menu:

Starter:

Red beet carpaccio. Served with frisee salad, with gratinated chevre (goat cheese) and lavender honey.

Main course:

Panfried house smoked salmon (served medium rare) with a spinach potato nest and pepperroot hollandaise sauce

Dessert:

Glacé de Bombe, 3 types of ice cream layered, with a fruit center and coated with chocolate. Served with crème anglaise.

Visits on individual basis:

The Black Diamond, (free entrance)

The National Museum, Ny Vestergade 10. (free entrance), new courtyard 1997.

The State's Museum of Art, Øster Voldgade. (free entrance), extension 1997 by C.F. Møller Architects.

Øksnehallen, Halmtorvet 11. Restored 1993. - An old slaughterhouse, rebuild for exhibition purposes.

DAC – Danish Architectural Center, Strandgade 27B,
exhibition about Copenhagen.

The Danish Jewish Museum, 2003 by Daniel Liebeskind.
(open 13-16)

“Ørestad South”

VM-houses 2004, Plot Architects,
The Signal House 2007, Nobel Architects
Ørestad Highschool, 3XN Architects 2007.

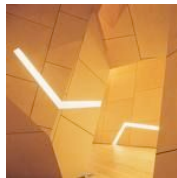

Jewish
Museum



VM-houses



The States museum
of Art



The National Museum



Ørestad Gymnasium



Øksnehallen

SATURDAY the 15th September

Tour of North Zealand (north of Copenhagen by chartered bus)



Map of North Zealand

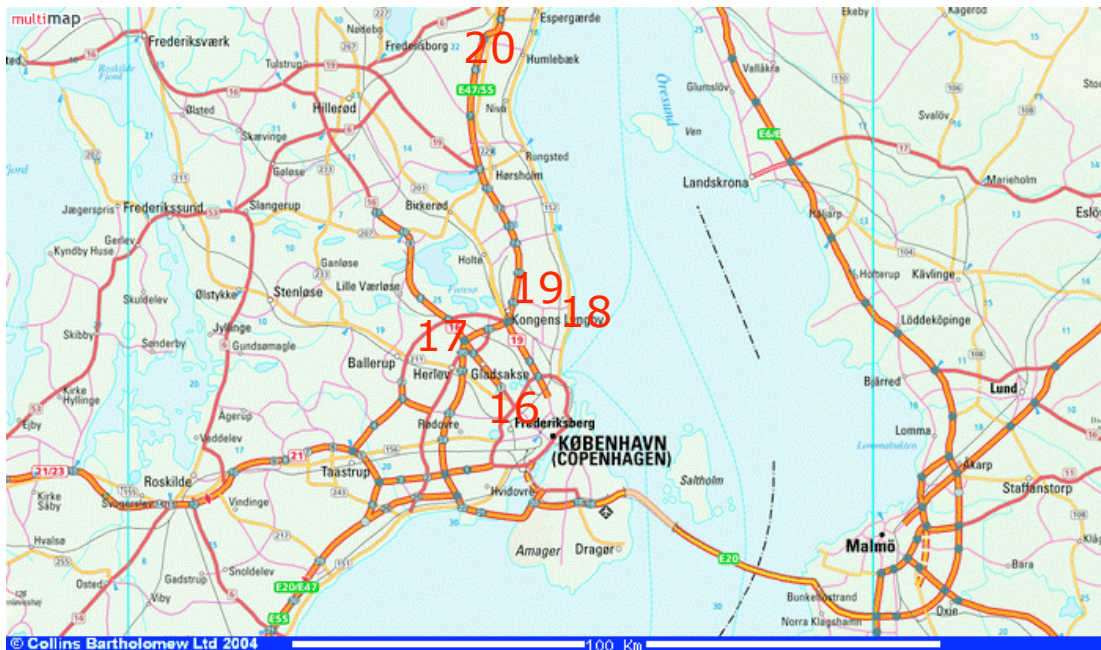

Map of North Zealand

08.30 Departure from the hotel.

09.00

Grundtvigs Church, 1921-40 (16)

Architect P. V. Jensen Klint and his son Kaare Klint. A monumental work inspired by the Gothic style, built as a memory of the poet and priest N.F.S. Grundtvig. The architect called the church a large Danish village church. The whole church and all its decorations is built of yellow brick stones.

09.45

Bagsværd Church, 1976 (17)

Architect Jørn Utzon. Industrial like facades cover a biomorph inner room. Utzon was inspired by the drifting clouds in the sky, when he designed the inner room and this makes an interesting contrast to the "closed" facades.



Bagsværd Church Interior

Grundtvigs Church

10.45

We drive through the Klampenborg district before we enter the Ordrup Gaard Museum on our way to Louisiana.

In Klampenborg (18) a lot of Arne Jacobsen's houses are situated from the Bellevue Theater to the Søholm rowhouses – and the Bella Vista residence - all built in the period from 1931 – 1954.



tower on the beach and a corner of the Bella Vista housing Klampenborg

11.00

Ordrupgaard Museum, Extension, 2003 (19)

Architect Zaha Hadid. The great blackish-gray concrete shell doubles the museum's space and holds new exhibition rooms, a multipurpose hall, a foyer and a café. The experience of space is a keyfeature to

the new annex, which both harmonizes and contrasts with the fine old original house of Ordrupgaard.



Ordrupgaard



Ordrupgaard

12.30 Arrival Louisiana, Humlebæk.

Louisiana, Museum of Modern Art (+concert hall) (20)

Architects Vilhelm Wohlert and Jørgen Bo, 1958.

The founder of Louisiana Knud W. Jensen bought the old villa built in 1856 to house his own private collection of Danish art. In 1958 he opened the villa and an extension of the villa as a museum to the public.

New wings were added in 1966 and 1971. In 1976 the Concert Hall followed, and in 1982 the South Wing was built. Finally, the wing for drawings and graphic art was completed in 1991 and an extension of the Louisiana shop was added in 1998.

The architects were inspired by the grounds and the park, with its beautiful old trees, a small lake and views of the "Øresund" which means that all the buildings are very interegrated in the landscape.

The exhibition **The Frontiers of Architecture I: Cecil Balmond**, (creative engineer of Arup) is shown. The exhibition is focusing on the relationship between science and architectural design, and gives an idea about to where architecture is heading today - implementing new geometries, ideas and computer generated forms.

12.30 Lunch at Louisiana. We deliver a lunchticket each, at the desk in the Café, get our lunch and find ourselves a nice place at the terrace (if the weather allows it).



Louisiana

- 14.30 Departure Louisiana for Kastrup Airport.
- 15.30 Check in at the airport.
- 17.25 Departure for Amsterdam.



Louisiana Concerthall



Louisiana Concerthall

ARKITEKTUR & KOMMUNIKATION

Dorte Augustenborg, arkitekt Maa., Bach. Kom,
Nordre Strandvej 119, 1. Sal, 3150 Hellebæk
mail: augustenborg@mail.dk T: +45 4970 2088
M: +45 :2284 9396 www.arkitours.dk